



# Installation

Model specific instructions

For:

- BMW K1200S
- BMW K1200R
- BMW K1200RS
- BMW K1200LT
- BMW K1200GT (03-04)
- BMW K1200GT (06-08)
- BMW K1300S
- BMW K1300R
- BMW K1300GT

These instructions are a model specific add-on to the general BoosterPlug installation instructions.

## Installation Tips

- **K1200S, K1200R, K1200GT (2006-2008), K1300S, K1300R, K1300GT:**
  - Remove the gas tank
  - Locate the AIT sensor in the air filter box
  - The pictures below should help you locate the sensor
  - Install the BoosterPlug module as per the general installation papers
  - You have several choices for the sensor location, but our favorite place is near the steering head or under the head light. Next to the airbox snorkel air intake hole is another very good spot.
  - Make sure that none of the four small idle tubes are squeezed flat by the BoosterPlug module when you reinstall the tank—otherwise the bike will run really weird
- **K1200RS, K1200LT, K1200GT (2003-2004)**
  - Remove the left hand side fairing to uncover the air filter box
  - Locate the AIT sensor in the front of the air filter box
  - The pictures below should help you locate the sensor
  - Install the BoosterPlug module as per the general installation papers
  - You have several choices for the sensor location, but our favorite place is near the steering head or under the head light. Next to the airbox snorkel air intake hole is another very good spot.

## Pictures

For:

- BMW K1200S
- BMW K1200R
- BMW K1200GT (06-08)
- BMW K1300S
- BMW K1300R
- BMW K1300GT

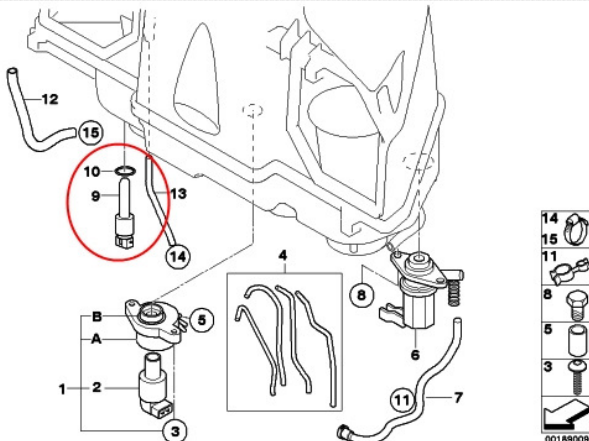

For:

- BMW K1200RS
- BMW K1200LT
- BMW K1200GT (03-04)

