



# Installation

Model specific instructions

These instructions are a model specific add-on to the general BoosterPlug installation instructions.

For:

- **Suzuki Intruder VL1500**  
(2013 - up) (L3 - up)
- **Suzuki Boulevard C90**  
(2013 - up) (L3 - up)
- **Suzuki Intruder M1800R**  
(2006 - up) (K6 - up)
- **Suzuki Boulevard M109R**  
(2006 - up) (K6 - up)
- **Suzuki Intruder C1800R**  
(2008 - 2012) (K8 - L2)
- **Suzuki Boulevard C109R**  
(2008 - 2012) (K8 - L2)

## Installation Tips

- Install the BoosterPlug module as per the general installation papers.
- The pictures below should help you locate the AIT sensor where the BoosterPlug is installed.
- The AIT sensor is located in the central air intake collector box (See pictures below).
- You have several choices for the BoosterPlug sensor location, but our favorite place is near the steering head or under the head light. Next to the airbox snorkel air intake hole is another very good spot.
- Just stick to the simple rules in the general installation instructions for placing the external sensor, and you'll be fine.

## Pictures

For:

- **Suzuki VL1500 Intruder / Boulevard C90**

FIG.18

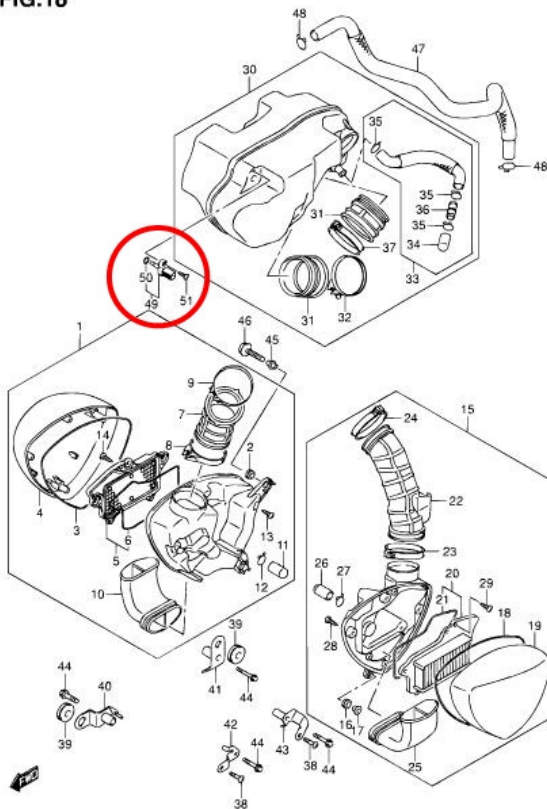

For:

- **Suzuki Intruder 1800 / Boulevard 109**

FIG.14

