



# Installation

Model specific instructions

For:

- [Honda VTX1800 \(All models\)](#)

These instructions are a model specific add-on to the general BoosterPlug installation instructions.

## Installation Tips

- Install the BoosterPlug module as per the general installation papers.
- The pictures below should help you locate the AIT sensor where the BoosterPlug is installed.
- The AIT sensor is located on the inside of the air filter box.
- You have several choices for the BoosterPlug sensor location, but our favorite place is near the steering head or under the head light.
  - Just stick to the simple rules in the general installation instructions for placing the external sensor, and you'll be fine.

## Pictures

For:

- [Honda VTX1800 \(All models\)](#)

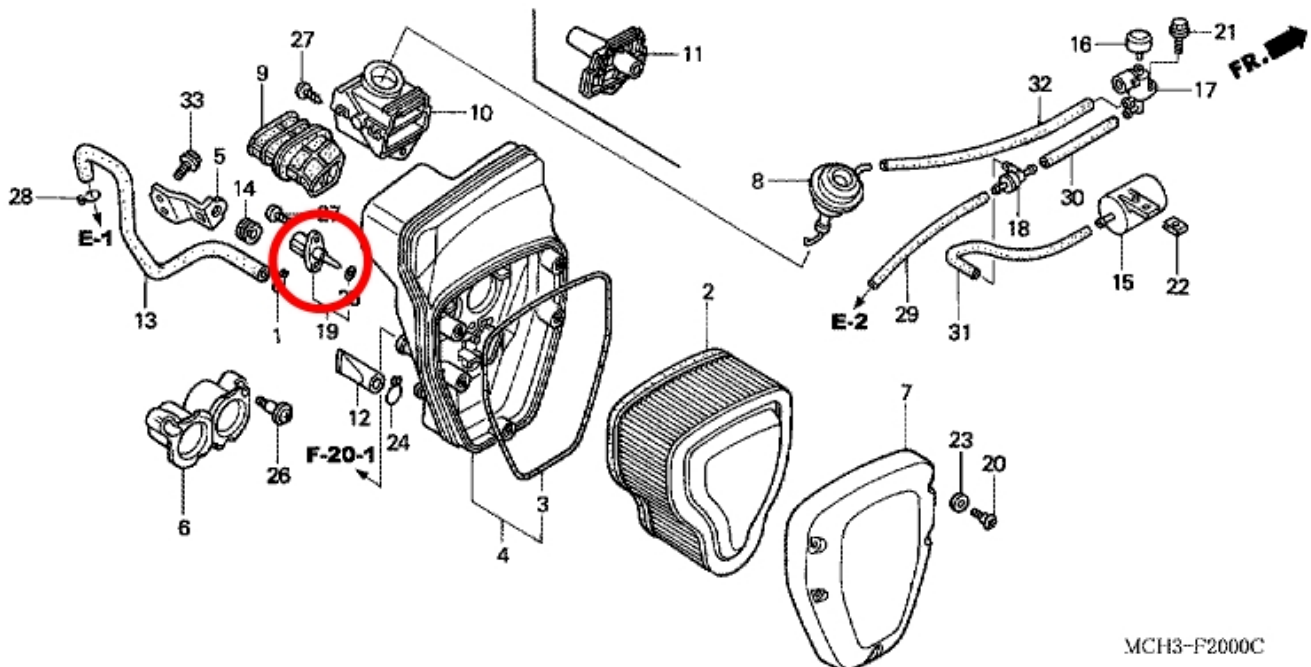

MCH3-F2000C